

Picture 3  
Wiring Diagram (Top View)

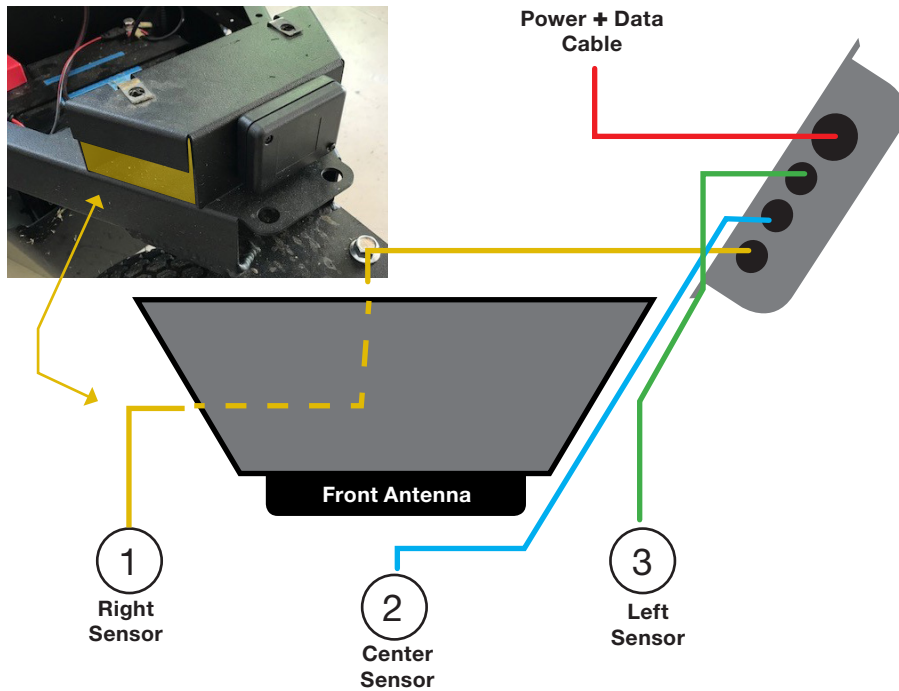

Picture 3A



# Tempo™

## WALK

### Ultrasonic Sensor Installation and Replacement Instructions



[www.clubcar.com](http://www.clubcar.com)

P.O. Box 204658, Augusta, Georgia 30917-4658 USA

Telephone 706-863-3000 Service Parts Fax 706-855-7413

Copyright © 2018, Club Car, LLC Club Car, Tempo Walk is a registered trademark of Club Car, LLC.

There is a Library of informational videos at  
[www.clubcar.com/tempowalkresources](http://www.clubcar.com/tempowalkresources)

**Front Antenna**

**Sensor Box  
Location**

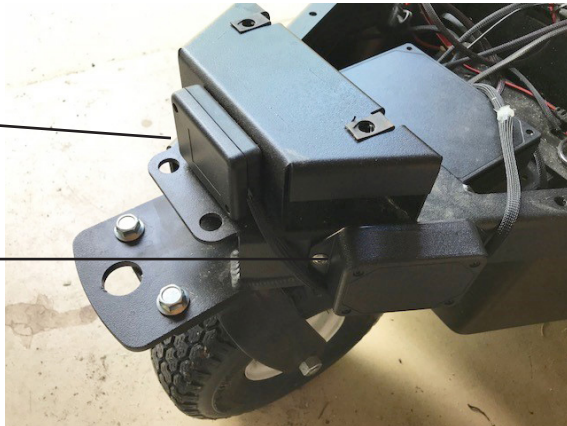

**Sensor Box**



**Sensor Placement**  
(Front View Tempo Walk  
Plastic Top)



**Back view of  
Ultrasonic Sensor**



## Ultrasonic Sensor Replacement Tips

- 1). Unscrew the middle of each broken sensor cable first.
- 2). Remove the sensors from the Tempo Walk plastic top by pushing them out from behind. (See pic 1)
- 3). Replace sensors, and make sure to orient correctly.  
**Note:** Handle sensors gently, insert by using outside edge, avoid pressing the center of sensor.
- 4). Route cables to stay above the front caster wheel. (See pic 2)
- 5). Screw in firmly each sensor connector to its corresponding cable. (See pic 3A)
- 6). Test sensors when Tempo Walk is powered on to make sure they are operating correctly

## HOW TO RESET “DISABLED” SENSORS OR SYSTEM

Once the necessary repairs have been made, follow these steps.

**Step 1:** Turn on the Tempo Walk, and wait for the start-up chime

**Step 2:** Wait for the audio about the disabled sensors  
(approx. 5 secs)

**Step 3:** Press the neutral button “N” twice  
(Located on the dashboard)

Picture 1

### Ultra Sonic Sensor Box

Top of sensor is positioned at  
the 12 o'clock position and the  
cable at the 6 o'clock position

Tempo Walk Cover

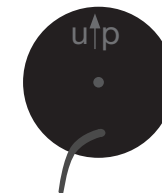

Press Clips (●) in  
to move forward.

