





LED	Explanation
<p>25% Red LED</p> <p>25% 50% 75% 100%</p> 	<p>The 25% Charge LED will slowly pulse "on" and "off", when the battery is less than 25% fully charged. When the battery is 25% charged, the red Charge LED will be solid.</p>
<p>50% Red LED</p> <p>25% 50% 75% 100%</p> 	<p>The 50% Charge LED will slowly pulse "on" and "off", when the battery is less than 50% fully charged. When the battery is 50% charged, the red Charge LED will be solid.</p>
<p>75% Orange LED</p> <p>25% 50% 75% 100%</p> 	<p>The 75% Charge LED will slowly pulse "on" and "off", when the battery is less than 75% fully charged. When the battery is 75% charged, the orange Charge LED will be solid.</p>
<p>100% Green LED</p> <p>25% 50% 75% 100%</p> 	<p>The 100% Charge LED will slowly pulse "on" and "off", when the battery is less than 100% fully charged. When the battery is fully charged, the green LED will be solid, and the 25%, 50% and 75% Charge LEDs will turn "off".</p>
<p>Maintenance Green LED</p> <p>25% 50% 75% 100%</p> 	<p>During maintenance charging, the 100% Charge LED will pulse "on" and "off" slowly. When the battery is topped off and fully charged again, the 100% Charge LED will turn solid green. The charger can be left connected to the battery indefinitely.</p>

Figure 16 NOCO G7200 Charger Status Indicators

CHARGING PROCEDURES

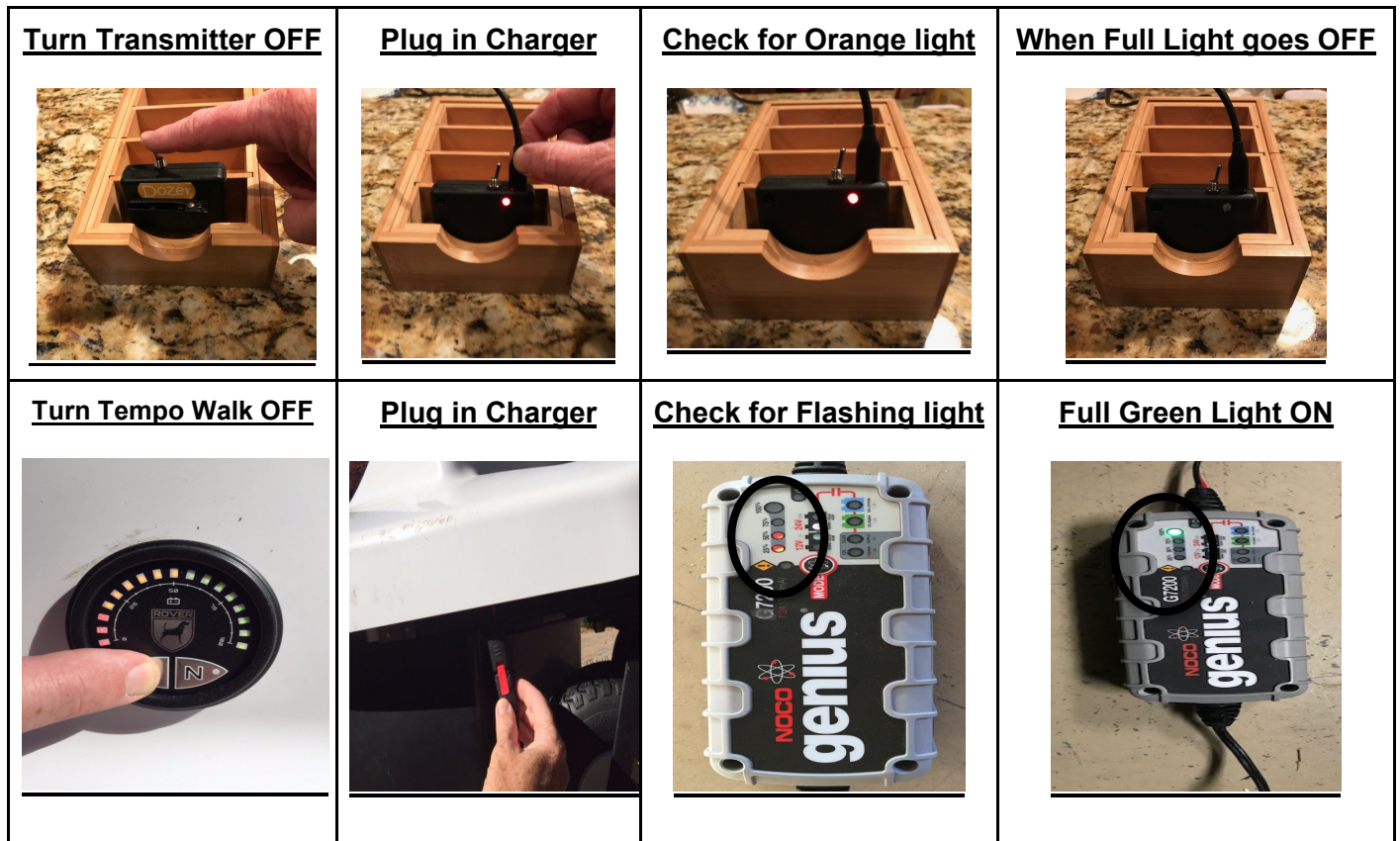

Figure 17 Transmitter and Tempo Walk Charging Steps

CHARGING BATTERY

See Dangers and Warnings at Battery Charger beginning on page 26.

⚠ WARNING

- Be sure all wire connections at the receptacle are clean and tight.
- Do not rock or bend the plug. To connect the charger plug to the unit receptacle, grasp the plug tab and push the plug straight into the receptacle.
- Do not pull on the charger cord (Figure 18) use the red spring release to disconnect the plug. Do not twist, rock or bend the plug. To disconnect the charger plug from the unit receptacle, grasp the plug by the tab, press the red spring release, and pull the plug straight out of the receptacle.
- Do not connect a charger to the receptacle if the charger cord, plug, or the unit receptacle is broken, damaged in any manner, or does not make a good electrical connection. Fire or personal injury can result. Have it replaced by a qualified service person immediately. Failure to follow these instructions could result in damage to the charger cord, the plug, and (or) the unit receptacle.
- Do not attempt to charge frozen batteries or batteries with bulged cases. Discard the battery in accordance with all environmental laws or return to an authorized Club Car dealer. Frozen batteries can explode.

- Do not use a charger if any of the following conditions exist:
 - The plug is too loose or does not make a good connection.
 - The plug and receptacle feel hotter than normal during charge.
 - The plug pins or receptacle contacts are bent or corroded.
 - The plug, receptacle, or cords are cut, worn, have exposed wires or are damaged in any way.
- Using the charger with any of the above symptoms could result in a fire, property damage, personal injury, or death.

CAUTION

- On all units, turn off Tempo Walk before charging battery.
- The battery charger provided with this unit is approved for use only with the battery type originally shipped with the unit. Using a different battery type (different brand, different capacity, etc.) can cause under or overcharging and subsequent battery damage. Club Car recommends only OEM replacement battery. Contact your authorized Club Car dealer/distributor with any questions about battery and charger compatibility.

Battery Charging Procedure

1. With the charger cord disconnected from the unit charger receptacle, connect the power supply cord to an outlet designed to provide the proper voltage for the NOCO G7200 charger.
2. Insert the charging plug into the unit receptacle. When inserting the charging plug, align the raised guide on the plug with the guide slot in the receptacle and push straight in slowly (Figure 18).
3. The charger will turn on in two to five seconds later, after the lockout function activates.
4. As long as the charger is allowed to shut off by itself, the battery will be fully charged. Overcharging and undercharging will normally be prevented.
5. If the charger does not seem to be operating properly, or if the battery seems weak, contact your local Club Car distributor/dealer.



Figure 18 **CORRECT** Insertion of Charger Plug



Figure 19 **INCORRECT** Insertion of Charger Plug